

OUTDOOR SERIES
DOD651PHXXLS

FEATURES

Stainless steel wrapped exterior

Premium height-adjustable upper rack and premium lower rack

Heavy-duty stainless steel construction

Nylon-coated steel racks

TouchProof™ stainless steel

Condensation drying system

15 place-setting capacity

Quiet operation—48 dB(A)

7Spray™ wash system

Hidden controls

LED lit interior

LED display

Delayed start

UL outdoor approved

PROGRAMS

- Normal Wash
- Eco Wash
- Sanitation Wash
- Time Program
- Plastic Wash
- Hygiene Wash
- Crystal Glass
- Self-Cleaning
- Rinse and Hold

PRODUCT SPECIFICATIONS

Model	DOD651PHXXLS
Width	24 ⁵ / ₈ "
Height	34 ¹¹ / ₁₆ " – 35 ¹¹ / ₁₆ "
Depth	25"
Door Clearance	24 ⁵ / ₈ "
Weight	174 lb
Electrical Supply	115 VAC, 60 Hz
Service	15 amp dedicated circuit (GFCI)
Receptacle	3-prong grounding-type
Power Cord	4'
Water Connection	6" PEX tubing with 3/8" NPT female connection
Drain Connection	5' corrugated tubing
Pressure	4.2–140 psi

Electrical supply, plumbing supply, and drain should be located in an adjacent cabinet. If not, they must be located within the shaded area shown in the illustrations below.

ELECTRICAL | PLUMBING



DIMENSIONS

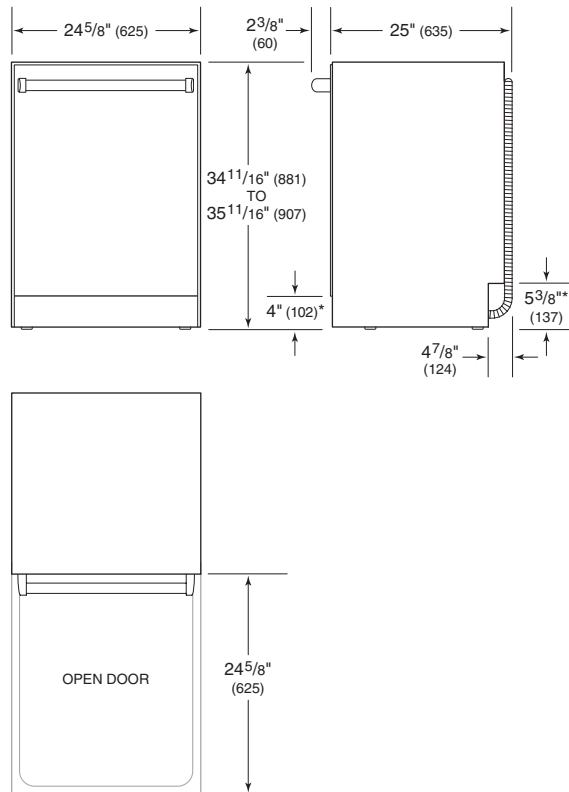

*Dimension will vary with product height.

INSTALLATION

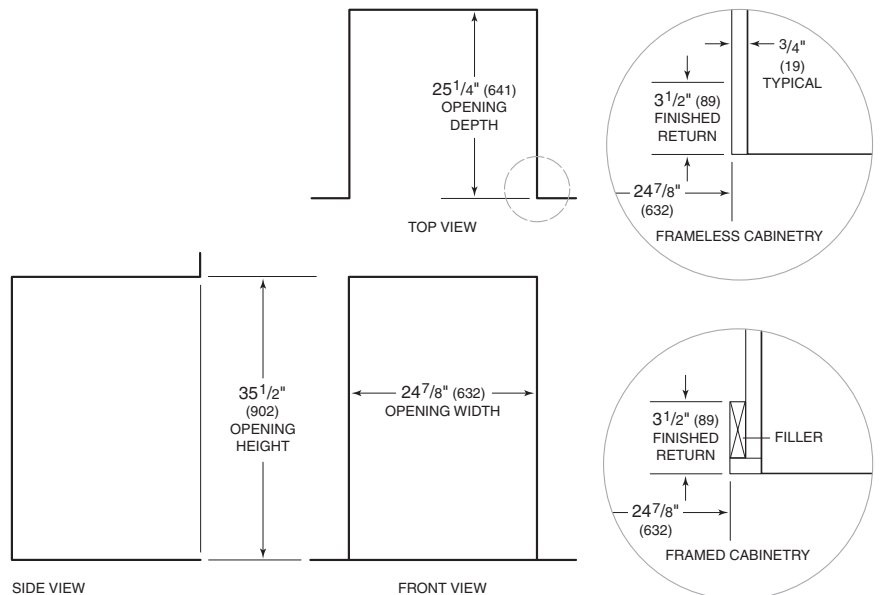

NOTE: 3 1/2" (89) finished returns will be visible and should be finished to match cabinetry.